

# National Workshop on Christian Unity - 2006 Daily Schedule

## Monday, May 8

### AM

- 7:15-8:15 EDEIO Eucharist (all welcome) – Cupertino Room
- 8:30-4:00 NWCU & Network Registration – South Tower 2<sup>nd</sup> Floor Foyer**
- 8:30-10:00 EDEIO Executive Committee Breakfast meeting (\* ticket required) – Valley Room
- 9:00-11:45 NEOA Board Meeting – Gold Room
- 9:30-3:00 NADEO Executive Board Meeting – California Room
- 10:30-11:30 EDEIO Newcomers Orientation – Valley Room

### PM

- 1:00-2:45 LERN Executive Committee meeting – Gold Room
- 1:00-2:15 EDEIO Business Plenary #1 – Crystal Room
- 2:00-3:00 NADEO Orientation – Cupertino
- 3:00-5:30 LERN Plenary – Sacramento Room
- 3:00-4:00 ECCO Network Orientation – Valley Room – Conference Level
- 2:30-4:45 EDEIO Provincial meetings – Crystal Room
- 4:00-4:45 NWCU Newcomers' Orientation – Glen Ellen Room**
- 5:00-6:45 EDEIO Banquet (\* ticket required) – Club Regent
- 5:00-6:00 NADEO Regional meetings – Glen Ellen/Cupertino
- 5:00-6:30 NCCC Reception (all welcome) – Fountain Restaurant
- 6:00-9:30 Vesting Room for worship procession participants not staying in Hotel – Belvedere (room to be locked during the procession and service)**
- 7:00-9:00 NWCU Opening Worship & Reception at the Cathedral Basilica of Saint Joseph: Rev. Dr. George Cummings, Preacher (a block north of hotel) *Note: An offering will be taken for Louisiana Interchurch Conference to support their Hurricane Katrina Recovery Efforts***

+ + +

## Tuesday, May 9

### AM

- 8:15-8:30 MWCU Morning Prayer – Imperial Ballroom
- 8:30-4:00 NWCU & Network Registration – South Tower 2<sup>nd</sup> Floor Foyer
- 8:45-10:15 Opening Plenary and Keynote Address – Rev. Dr. Richard Mouw, "Evangelicals and Ecumenism" Imperial Ballroom
- 10:00-4:00 Bookstore and Displays Open – South Tower 2<sup>nd</sup> Floor Foyer
- 10:30-11:45 NWCU Morning Seminars
- 1 ARCIC Document on Mary – Sacramento
  - 4 The Ecumenical Dialogue in Perspective – Cupertino
  - 7 Lutheran/Roman Catholic Document, *Communio Sanctorum* – Piedmont
  - 8 Life Issues & Science – Religion – Glen Ellen
  - 10 Ecumenical Reception and the Grassroots Church – Belvedere
  - 11 Seminarian Essay Contest – Hillsborough
  - 12 WCC Porto Alegre Assembly – Fairfield
  - 13 Ecumenism 101 – Receive One Another – Hospitality in Ecumenical Perspective – Atherton

### PM

- 12:00-1:45 ECCO-EDEIO-LERN Luncheon (\* ticket required) – Panel: Ms. Diane Lowe and Dr. Aurela Fule, "Evolving Nature of Lutheran/Reformed Full Communion" – Club Regent (1<sup>st</sup> Floor Lobby)
- 12:00-1:45 NADEO Luncheon (\* ticket required) – Speaker: Rev. Thomas Rausch, "Ecumenism & the Hispanic Community" – Imperial Ballroom
- 2:00-3:30 ECCO-EDEIO-LERN Seminar – Panel: Dr. Rod Dugliss, Rev. Russell Meyer & Lydia Veliko, "Critical Issues in Ecumenism Today" – Club Regent
- 3:00-4:15 NADEO Seminars – Atherton/Belvedere/Cupertino
- 3:45-5:00 EDEIO Seminar #1 (Open to Workshop Registrants) – Panel: Rev. Betty Gamble (UMC) and Very Rev. David Bird (ECUSA), "Update on the United Methodist-Episcopal Dialogue" – Fairfield
- 4:00-5:30 LERN Caucus – Sacramento
- 4:30-5:45 NADEO Seminars – Atherton/Belvedere/Cupertino
- 6:15-8:00 EDEIO-LERN Eucharist & Informal Reception: (All Welcome) Trinity Episcopal Cathedral, 81 North Second Street

+ + +

\* ticket required: Any luncheon so indicated is by advance registration made through the specific sponsoring network. No meal ticket will be available at the door. The luncheon precedes the talk. Those wishing to hear a particular speaker will be admitted into the room without cost, after the luncheon.

## Wednesday, May 10

### AM

- 8:15-8:30 Morning Prayer – Imperial Ballroom
- 8:30-4:00 NWCU & Network Registration – South Tower 2<sup>nd</sup> Floor Foyer
- 8:45-10:15 NWCU Plenary Bible Study– Sr. Dr. Dianne Bergant, CSA, Leader – Imperial Ballroom
- 10:00-4:00 Bookstore and Displays Open – South Tower 2<sup>nd</sup> Floor Foyer
- 10:30-11:45 NWCU Morning Seminars
- 1 ARCIC Document on Mary – Sacramento
  - 2 Christian Churches Together in the USA – Hillsborough
  - 5 Human Sexuality & Ecclesiology – Belvedere
  - 7 Lutheran/Roman Catholic Document, *Communio Sanctorum* – Piedmont
  - 9 The Church Global and Local – Unity in Church and Mission - Cupertino
  - 12 WCC Porto Alegre Assembly – Fairfield
  - 14 Ecumenism 201 – National/International – Atherton
  - 15 Christian Jewish Dialogue – Glen Ellen

### PM

- 12:00-1:45 LARC Luncheon (\* ticket required) – Speaker: Archbishop John Quinn, "Papal Authority" – Imperial Ballroom
- 12:30-1:45 ECCO Luncheon – Trinity Episcopal Cathedral (\* ticket required) 81 N. 2nd. St.
- 2:00-5:00 ECCO Network meetings – Trinity Episcopal Cathedral (\* ticket required), 81 N. 2nd. St.
- 2:00-3:15 EDEIO Seminar #2 (Open to Workshop Registrants) – Speaker: Rev. Dr. Gwynne Guibord, "Interreligious Issues and Dialogue" – Fairfield
- 2:30-5:00 LERN Plenary – Sacramento
- 3:00-5:00 NADEO General Assembly – Atherton
- 3:30-4:45 EDEIO Business Plenary #2 – Fairfield
- 5:00-6:15 NADEO Eucharist – St. Joseph's Cathedral Basilica
- 5:30-6:30 CUIC Worship Service – First Christian Church, 80 S. 5th Street
- 7:00-9:30 NWCU Local Social Event – Trinity Episcopal Cathedral

+ + +

## Thursday, May 11

### AM

- 8:15-9:15 NWCU Plenary Bible Study – Sr. Dr. Dianne Bergant, CSA, Leader – Regency Ballroom
- 8:30-4:00 NWCU & Network Registration – South Tower 2<sup>nd</sup> Floor Foyer
- 9:30-10:45 NWCU Morning seminars
- 2 Christian Churches Together in the USA – Hillsborough
  - 3 Latino Clergy/Leaders Forum – Fairfield
  - 4 The Ecumenical Dialogue in Perspective – Piedmont
  - 5 Human Sexuality & Ecclesiology – Belvedere
  - 6 Interreligious Dialogue – A Pastoral Perspective – Sacramento
  - 8 Life Issues & Science-Religion – Glen Ellen
  - 9 The Church Global and Local – Unity in Church and Mission – Atherton
  - 10 Ecumenical Reception and the Grassroots Church – Cupertino
- 11:00-11:45 NWCU Closing Address – Rev. Dr. Kevin Mannoia – Regency Ballroom
- 11:45-1:00 NWCU Closing Luncheon (\*\* ticket required) – Regency Ballroom

+ + +

### Post Workshop Events

### PM

- 1:00-2:15 NPC Meeting for Review and Transfer of Chairs – Glen Ellen
- 2:30-5:00 EDEIO Executive Committee 2007 Planning Meeting – Atherton
- 2:30-5:00 LERN Executive Committee 2007 Planning Meeting – Cupertino
- 2:30-5:00 NADEO Executive Board 2007 Planning Meeting – Belvedere
- 2:30-5:00 ECCO Executive Committee – Fairfield
- 6:00-9:00 ECCO-EDEIO-LERN-NADEO Annual Evening Prayer and Network Executive Boards Dinner (\* invitation only) – Trinity Episcopal Cathedral

### Friday, May 12

- 9:00-6:00 National Planning Committee Meeting – Glen Ellen

+ + +

\*\* ticket required, included as part of the NWCU registration fee.

## Keynote Presenters

**Rev. Dr. George Cummings (Preaching at the Opening Worship Service)** is an internationally known theologian and pastor whose ministry extends around the world. He is the founding pastor of Imani Community Church (Baptist); and the Pearl Rawlings Hamilton Professor of Systematic Theology at the American Baptist Seminary West, (ABSW) in Berkeley, California. He has been a teacher at ABSW for twelve years, and is currently serving as the Dean. His ministry has been characterized by his commitment to pastoral ministry as the appropriate context of theological scholarship. Dr. Cummings has a global vision for his vocation as a theologian and a pastor. In his work as a scholar, his primary interest is exploring African-American religious and cultural traditions. He believes that churches must be involved in the religious, cultural, political, economic and educational life of the community; and that "...we must strive to become all that God calls us to be." His objective is to discover theological insights that can inform the current struggle of Africans for liberation.

**Rev. Dr. Richard J. Mouw (Keynote Speaker)** is president of Fuller Theological Seminary in Pasadena, California, an evangelical institution which, with over 4000 students, is the largest seminary in North America. He received his B.A. in English from Houghton College, an M.A. in Philosophy from the University of Alberta, and the Ph.D. in Philosophy from the University of Chicago. He also studied theology at Western Theological Seminary in Holland, Michigan. He taught in the Calvin College Philosophy Department for seventeen years before joining the Fuller faculty as Professor of Christian Philosophy in 1985. He was appointed Provost at Fuller in 1989 and President in 1993. Mouw has served on the Faith and Order commission of the NCCC, the Board of the Institute for Ecumenical and Cultural Research, and the Committee of Visitors at Harvard Divinity School. He is the author of fourteen books, the most recent being *Calvinism in the Las Vegas Airport*. The Military and Hospitaller Order of St. Lazarus of Jerusalem is pleased to sponsor the Keynote address. It is a 900 year old Order of Chivalry and is ecumenical – dedicated to service to others and to Christian unity.

**Sr. Dr. Dianne Bergant, CSA (Bible Study Leader)** is Professor of Biblical Studies at Catholic Theological Union in Chicago. She was President of the Catholic Biblical Association of America (2000-1) and has been an active member of the Chicago Catholic/Jewish Scholars Dialogue for the past nineteen years. She is the Old Testament book reviewer of *The Bible Today*, having been a member of the editorial board for twenty-five years. Five of these years she served as the magazine's general editor. She is now on the editorial boards of *Biblical Theology Bulletin* and *Preach*. She wrote the weekly column "The Word" for *America* magazine (2002-5). She is currently working in the areas of biblical interpretation and biblical theology, particularly issues of peace, ecology and feminism.

**Dr. Kevin Mannoia (Closing Address)** is Chaplain of Azusa Pacific University's Graduate and Professional programs. Dr. Mannoia received his B.A. from Roberts Wesleyan College, his MDiv. from Trinity Evangelical Divinity School and a Ph.D. from the University of North Texas. Prior to his appointment at APU, he served as Dean of Haggard School of Theology at APU, coming from his role as President of the National Association of Evangelicals. From his experience as a pastor, superintendent, bishop of the Free Methodist Church and President of the NAE, Mannoia brings his understanding of the church at a congregational, organizational, denominational and national level to Azusa Pacific University. Having grown up in Brazil and invested much of his ministry overseas, Dr. Mannoia lives as a world Christian, while being active in his local community as an active member of local and county school districts. He has served as a guest faculty member at Holy Light Theological Seminary in Kissing, Taiwan; the Asian Theological Association; and the Asian Graduate School of Theology in Bangalore, India. He served as a Trustee for Roberts Wesleyan College, Northeastern Seminary in Rochester, N.Y., and Seattle Pacific University. He regularly serves as resource person and speaker to pastors' conferences, churches, and retreats. Dr. Mannoia's books include *Church Planting: The Next Generation*; *Century 21 Church Planting Manual*; and *The Integrity Factor: A Journey in Leadership Formation*.

---

The points of view expressed by NWCUC presenters are those of the person making the presentation and do not necessarily represent the planning committee or the churches who sponsor the Workshop.

## Morning Seminars

- 1 **ARCIC Document on Mary - Level Three (T) (W)** In 2004 the Anglican-Roman Catholic International Commission (ARCIC) concluded an investigation of Mary in the Church's faith. An earlier agreed statement had identified the Anglican difficulty with the Roman Catholic dogmas of the Immaculate Conception and the Assumption. The new statement, published in 2005, does not focus simply on these dogmas, but attempts a more comprehensive retrieval – a joint “re-reception” – of doctrine and devotion concerning Mary. As a result, ARCIC has been able to set out points of agreement on “the place of Mary in the economy of hope and grace.” **Presenters: Sr. Sara Butler, M.S.B.T & Dr. E. Rozanne Elder**
- 2 **Christian Churches Together in the USA - Level Two (W) (Th)** Dr. Granberg-Michaelson has been involved in each step of the process that is creating Christian Churches Together in the U.S.A. This seminar offers an introduction to the origin and history of CCT, an overview of the meaning, mission and organization of CCT-in-the-making, and reflections on the path ahead. **Presenter: Rev. Wesley Granberg-Michaelson**
- 3 **Latino Clergy/Leaders Forum - Level One (Th)** Latinos are the largest ethnic minority in the USA. But, Ecumenism among Latinos is minimal. The Forum will bring together Latino leaders from various communions to discuss ways of overcoming the obstacles to ecumenical work in the community and ways of furthering the unity of the church. **Presenters: Rev. Cesar Buitrago, Rev. Sylvestre Romero & Rev. José Rubio**
- 4 **The Ecumenical Dialogues in Perspective - Level Three (T) (Th)** A review of some of the more recent dialogue results and their implications. A discussion of the reception of ecumenical agreement and approaches to using the dialogues in pastoral ministry and local educational contexts. **Presenter: Br. Jeffrey Gros, FSC**
- 5 **Human Sexuality and Ecclesiology - Level Two (W) (Th)** What models and methodologies? What basic assumptions? What were the goals? What were the values carried through? What worked? What didn't? The seminar will focus on the Presbyterian Church USA and the United Methodist Church as case studies. **Presenters: Elder Scott Anderson & Rev. Betty Gamble**
- 6 **Interreligious Dialogue - A Pastoral Perspective - Level Two (Th)** A panel of leaders from several different faith traditions, who have been in dialogue and cooperative action with one another in the local setting for several years, will discuss their experiences and learnings. They will address such questions as, *"Why is interreligious dialogue important? What do we hope to achieve through the dialogue? What problems do we encounter? And what does it take to overcome those problems?* They will explore, frankly, the significance of different basic religious beliefs in establishing a relationship and communicating. **Presenters: Rabbi Dana Magat, Rev. Gerald Sakamoto (Buddhist), Maha El Ganaidi (Muslim), Rev. Jon Pedigo, Rev. Andrew Kille & Rev. R. Richard Roe (Moderator)**
- 7 **Lutheran/RC Document, *Communio Sanctorum* - Level Three (T) (W)** "The Church as Koinonia of Salvation: Its Structures and Ministries" is the recent product of round X of the US Lutheran-Roman Catholic dialogue. Round XI is now underway. What are the results of this recent dialogue on the way to full communion? What is the significance of recent parallel international conversations and the leadership of Pope Benedict XVI on this journey toward convergence and consensus? **Presenter: Dr. Michael Root**
- 8 **Life Issues & Science-Religion - Level One (T) (Th)** A discussion of the relationship of life issues such as ethics, end of life and abortion, and science-religion issues such as genetics and stem-cell research. **Presenters: Dr. Ted Peters & Dr. Marty Hewlett**

---

The points of view expressed by NWCUC presenters are those of the person making the presentation and do not necessarily represent the planning committee or the churches who sponsor the Workshop.

- 9 The Church Global and Local : Unity in Church and Mission - Level Two (W) (Th)** A new text, *Through Divine Love: The Church in Each Place and All Places*, has been prepared by the United Methodist-Roman Catholic USA dialogue. It deals with the Church as a communion (koinonia), its structures and its expression in baptism, holy communion/eucharist and mission. This seminar will be a review of the texts and its conclusions, with a response from an Anglican perspective. **Presenters: Dr. Dennis Doyle, Dr. Karen Scheib & Dr. Thomas Ferguson**
- 10 Ecumenical Reception and the Grassroots Church - Level Two (T) (Th)** This seminar will explore strategies for implementing ecumenical agreements and texts in the local church. One of the greatest challenges in the Church is how to “receive” agreements into the Church’s life so that real visible unity is increased. The work of state councils as well as local parish and educational, ecumenical formation will be discussed. **Presenters: Rev. C. Dana Krutz & Dr. Richard Linneberger**
- 11 Seminarian Essay Contest - Level One (T)** NWCUC 2006 marks the second year of a Seminary Essay Contest. This year’s workshop brings together three essay winners – Lutheran, Episcopal, and Roman Catholic – from seminaries throughout the country. These students will speak about unity and fellowship in the life of the church through an assessment of dynamic ecumenical documents. The seminar shall address the question: what constructive thought will seminary students give to church leaders about the present and future needs of Christian fellowship and unity in the country and in the world? Specific examples and contemporary challenges that enhance and hinder the search for Christian unity will be considered. **Introducer: Dr. Michael Trice**
- 12 WCC Porto Alegre Assembly - Level Two (T) (W)** This workshop will review the major issues coming out of the 9<sup>th</sup> Assembly and implications for U.S. churches and Christians. Rev. Winbush is an Assoc. Stated Clerk and Director of the Dept. of Ecumenical and Agency Relations of the Presbyterian Church (USA) and a delegate at the Assembly. She is the immediate past moderator of the WCC’s Justice, Peace, Creation Commission. **Presenter: Rev. Robina Marie Winbush**
- 13 Ecumenism 101 - Receive One Another – Hospitality in Ecumenical Perspective - Level One (T)** At weddings, baptisms, funerals Christians find themselves extending or receiving hospitality from another church tradition. Ecumenical hospitality among Christians can expand appreciation for ways we are called to love each other, receive the ideas of the other and stretch our understanding of the abundant nature of God’s love. Drawing on a recent RISK publication of the WCC, this workshop will explore some practical applications and provide a seedbed for growth in the ecumenical movement. **Presenters: Rev. Dr. Diane Kessler, Rev. Lydia Veliko & Rev. Dr. Edward O’Flaherty, SJ**
- Ecumenism 201 - National International (Wednesday only) - Level Two (W)** This seminar will provide an overview of current national and international ecumenical dialogues and activities and will explore current issues in ecumenical relations, geared toward the beginner and with an aim to help the newcomer to the NWCUC engage topics presented in more depth in other NWCUC settings. While the objective of this seminar is to provide basic ecumenical information, it is assumed that all participants have ecumenical experience and insight to share and active participation will be encouraged. **Presenter: Rev. Lydia Veliko**
- 15 Presbyterian Jewish Dialogue re: Divestment - Level One (W)** When issues such as divestment arise that threaten to destroy Interfaith Relationships it is important to open channels for honest dialogue. Northern California Jewish & Presbyterian leaders will share important learnings from one and one half years of dialogue arising from the Presbyterian Church’s decision to explore phased, targeted divestment from certain firms doing business in the Middle East, whose products are seen as contributing to the suffering of Palestinian or Israeli civilians. **Presenters: Rabbi Melanie Aron, Rev. Ben Daniel & Bart Charlow**

## Helpful Information

- Any luncheon indicated with an \* indicates a ticket is required by advance registration.
- Those wishing to hear a particular speaker may join the group after the luncheon.
- The closing luncheon indicated with \*\* means that a ticket is required. This ticket was included in your registration fee. Your name badge will serve as admission to the event.
- Look for messages, schedule changes, meeting updates, etc., in the registration area.
- An evaluation form is inserted in your packet. Your comments/responses will assist the planning committee as they prepare for the 2006 workshop. Before you depart, please place your completed form and your name badge in the boxes at the registration area.
- The logo affirms the cross as central to Christian unity. On either side of the cross is the outline of a chalice, which represents the real, although imperfect communion, and the anticipated full unity which is the goal of the ecumenical movement. The space between the chalice and the cross suggests the hands of prayer embracing the reconciling cross. The late John R. Fulton designed the logo for the National Workshop on Christian Unity.
- The points of view expressed by NWCU presenters are those of the person making the presentation and do not necessarily represent the planning committee or the churches who sponsor the Workshop.

**The Graduate Theological Union (Berkeley, California) is operating the bookstore on Tuesday and Wednesday, from 10 am to 4 pm. Please visit the bookstore that is located in the Registration Area near the Morning Seminar rooms.**

**Remember to mark your calendars for the 2007 National Workshop on Christian Unity, January 29 to February 1, 2007, in Washington, DC.**

## Acknowledgements

Appreciation to the following for their financial and in-kind support:

- The Military and Hospitaller Order of St. Lazarus of Jerusalem
- The Cathedral Basilica of Saint Joseph
- Trinity Episcopal Cathedral
- First Christian Church – Disciples of Christ
- Christ the Good Shepherd Lutheran Church – Registration Office
- The Council of Churches of Santa Clara County
- Michael & Mary Ellen Fox (who provided wines for the Gala Event).
- Diamond Oak, Geyser Peak, Simi, Pedroncelli, White Horse Vineyards, and Father Thomas Devereaux (who provided wines for the Reception following the Opening Worship).

## Acronyms

<b>CUIC</b>	Churches Uniting in Christ
<b>ECCO</b>	Ecumenical Colleagues: American Baptist (USA), AME, AME Zion, Christian Church (Disciples of Christ), CME, Friends, the International Council of Community Churches, Moravians, Presbyterian Church (USA), Reformed Church of America United Church of Christ, United Methodist Church, the Orthodox churches and others.
<b>EDEIO</b>	Episcopal Diocesan Ecumenical and Interreligious Officers
<b>LARC</b>	Lutheran, Anglican, Roman Catholic
<b>LERN</b>	Lutheran Ecumenical Representatives Network
<b>NADEO</b>	National Association of Diocesan Ecumenical Officers (Roman and Eastern Catholic)
<b>NAEIS</b>	National Association of Diocesan Ecumenical and Interreligious Staff
<b>NCCC</b>	National Council of the Churches of Christ in the USA
<b>NEOA</b>	National Ecumenical Officers Association
<b>NPC</b>	National Planning Committee of the NWCUC
<b>WCC</b>	World Council of Churches

## 2006 - Local Planning Committee Members

The Rev. Dr. Paul Masquelier, NWCUC Local Chair	Presbyterian Church, USA
James White, Treasurer	Evangelical Lutheran Church in America
The Rev. Vaughn Beckman	Disciples of Christ
The Very Rev. David Bird	Episcopalian
The Rev. Beate Chun, Co-Registrar	Evangelical Lutheran Church in America
The Rev. Dr. Diana Gibson	Presbyterian Church, USA
Elder Jane Odell	Presbyterian Church, USA
The Rev. P. T. Mammen	Church of the Nazarene
The Rev. Father Cornelius (Scott) McCarthy	Catholic
Roberta Rinde, Co-Registrar	Evangelical Lutheran Church in America
The Rev. R. Richard Roe	United Church of Christ
The Rev. Margo Tenold	United Methodist Church
The Rev. Father José Antonio Rubio	Catholic

# Fairmont Hotel – Ground Floor Map

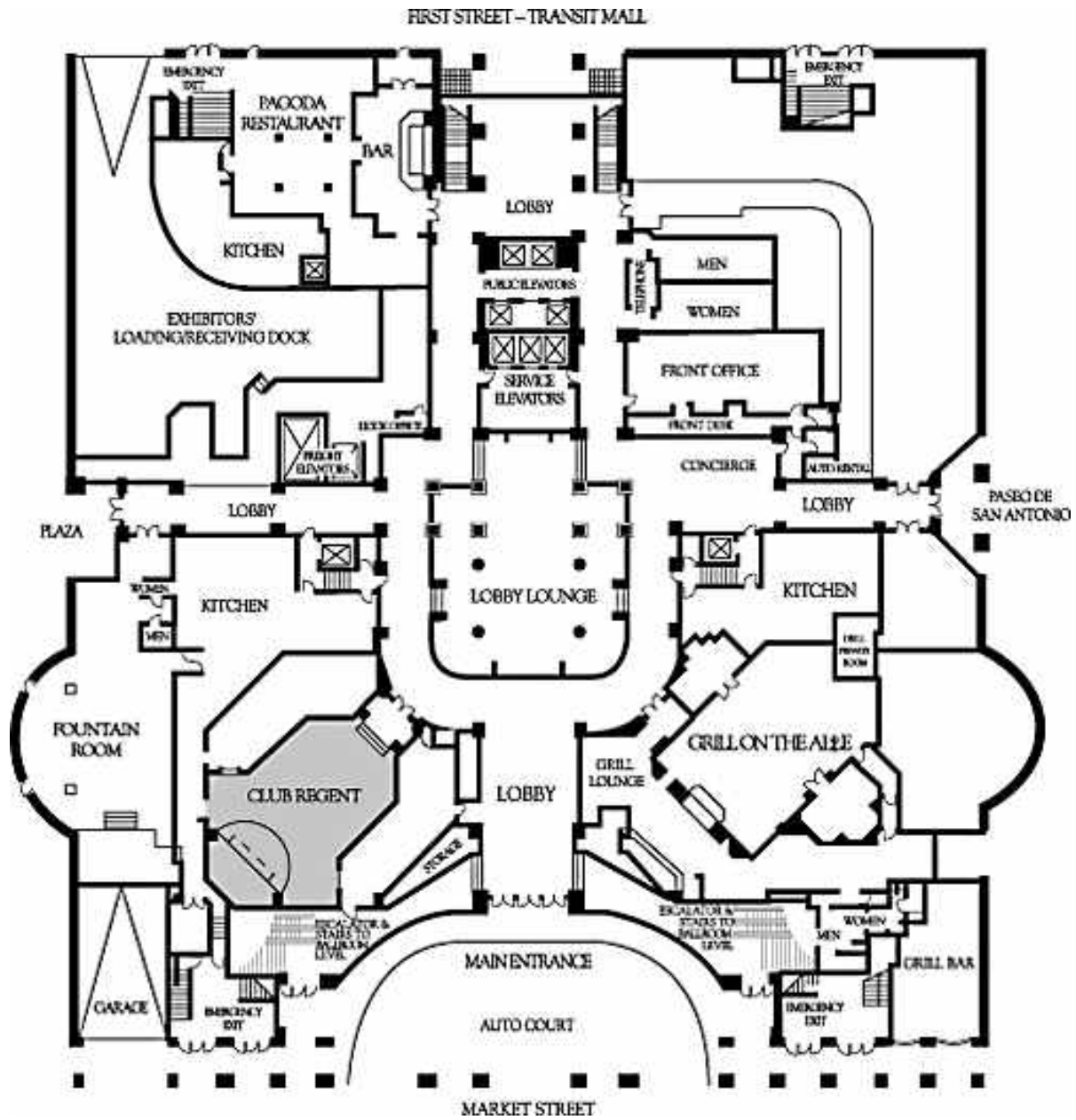

## Second Floor of Fairmont Hotel – Two Buildings Connected by a Bridge

